



# 1616 SOUTH VOSS

HOUSTON  
TEXAS

**CBRE**  
CB RICHARD ELLIS



## FEATURES AND BENEFITS

- Located at the intersection of San Felipe and Voss - only minutes away from the Galleria, I-10, Beltway 8, and the Westpark Tollway
- 179,061 square feet - 10 stories
- Well appointed, two-story glass-enclosed lobby
- Four high-speed elevators with dual control panels
- Ample garage parking with covered building entry
- Covered visitor parking
- Card-key garage and building access
- 24 hour courtesy officer
- Professional, on-site management
- Walking distance to quality shopping and restaurants

### TYPICAL FLOOR PLAN

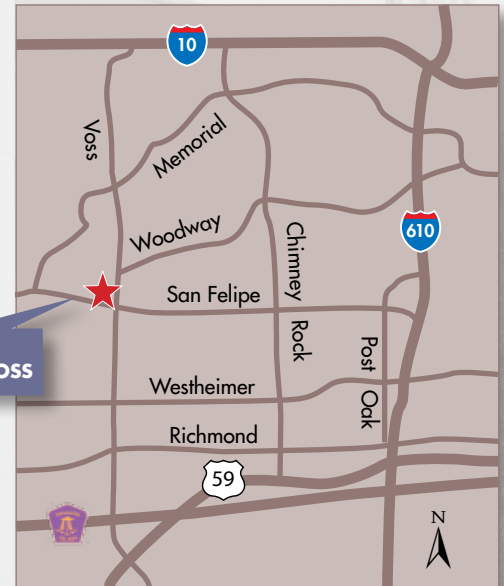
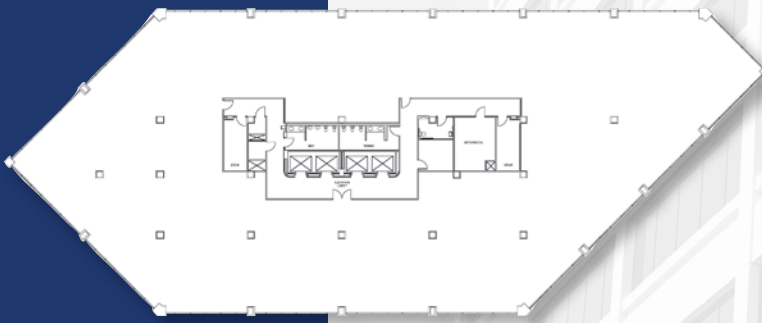

1616  
SOUTH VOSS

For leasing information, contact:

**KRISTEN RABEL, CCIM**  
713.577.1644  
kristen.rabel@cbre.com

**STEVE ROCHER**  
713.577.1615  
steve.rocher@cbre.com

**CBRE**  
CB RICHARD ELLIS

2800 Post Oak Blvd.  
Suite 2300  
Houston Texas 77056  
www.cbre.com



UNILEV MANAGEMENT CORPORATION  
TEL 713.273.7100  
FAX 713.273.7119

# 1616 SOUTH VOSS

HOUSTON  
TEXAS

We obtained the information above from sources we believe to be reliable. However, we have not verified its accuracy and make no guarantee, warranty or representation about it. It is submitted subject to the possibility of errors, omissions, change of price, rental or other conditions, prior sale, lease or financing, or withdrawal without notice. We include projections, opinions, assumptions or estimates for example only, and they may not represent current or future performance of the property. You and your tax and legal advisors should conduct your own investigation of the property and transaction. Printed in USA, Month/Year, Quantity/Printer Name, WR #